

GV-Mobile Server



INTRODUCTION

GV-Mobile Server is an application that can encode up to **32** video channels and subsequently allows for live view access from GV-IP Decoder Box, GV-Pad, and mobile devices including iPad, iPhone, iPod Touch and Android Smartphone. Third-party surveillance software can also access video channels from GV-Mobile Server through RTSP.

Through GV-Mobile Server, the clients can:

- access GeoVision and third-party channels connected to the GV-System.

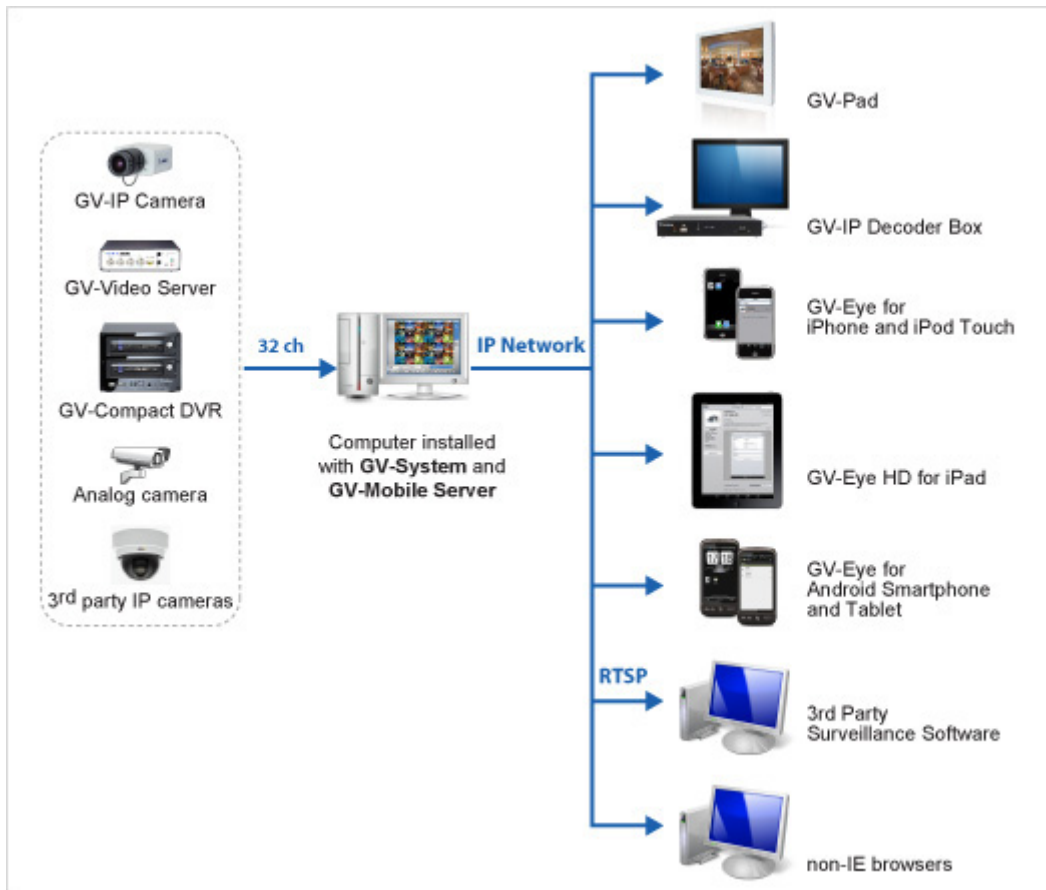

- access GeoVision and third-party IP channels connected to GV-Video Gateway / GV-Recording Server

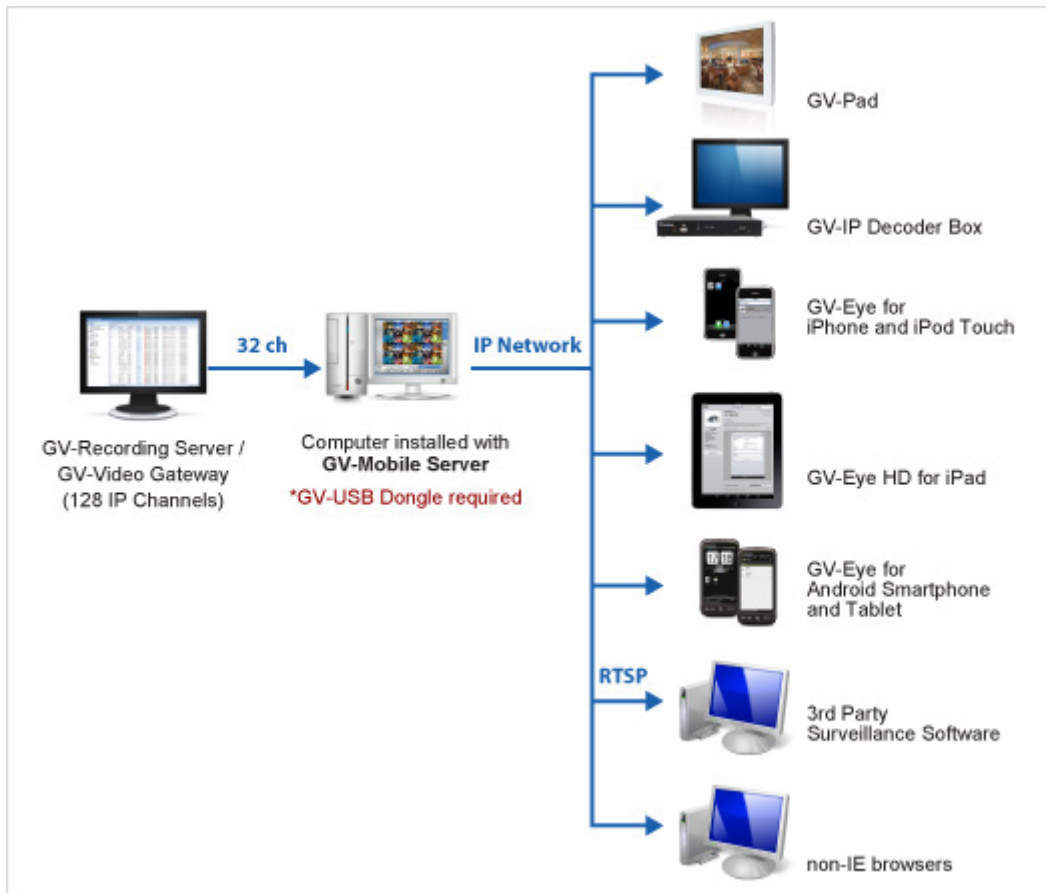

- directly access GeoVision and third-party IP devices

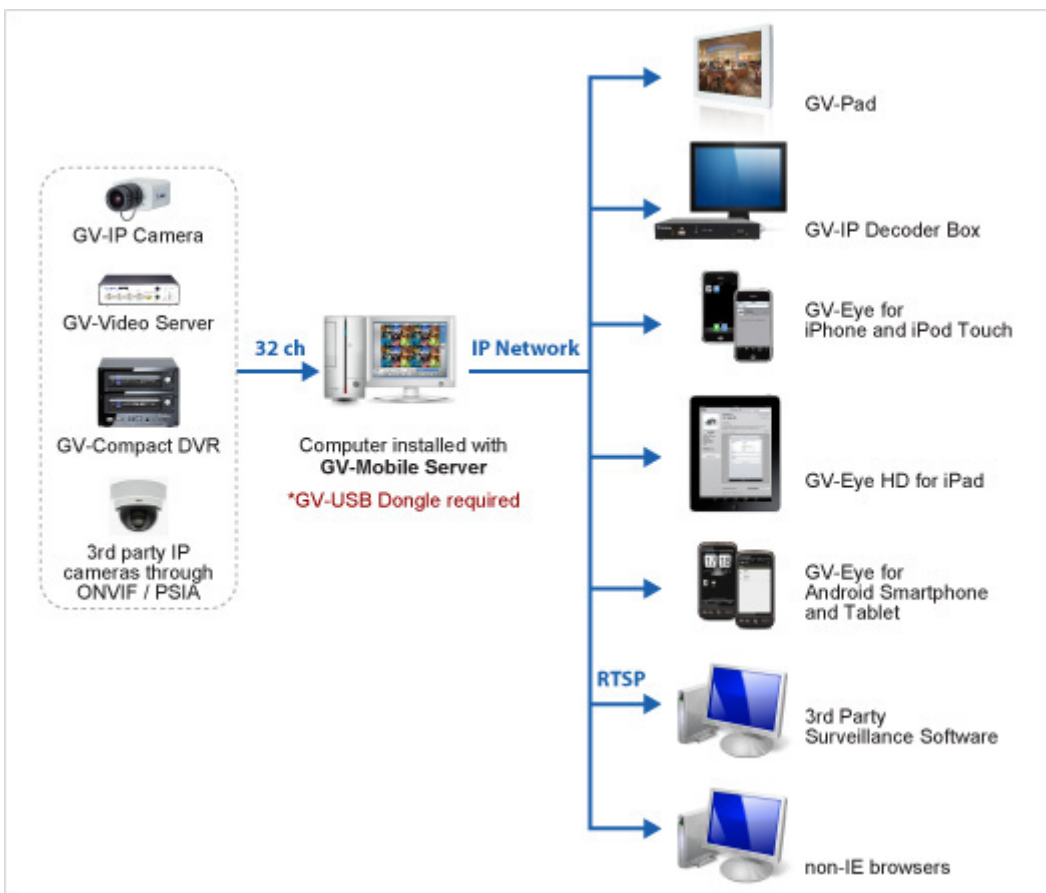

Features

- Live view access of analog cameras (connected to GV-System)
- Live view access of up to 4 user-selectable matrix channels
- Supports motion pop-up for matrix view
- Provides for dual streams
- Supports fisheye dewarping
- Significantly reduces CPU loading and bandwidth usage of IP video devices
- User-configurable frame rate, quality, codec type and resolution for each camera stream
- Remote access to live view using non-IE browsers

Minimum System Requirements

Depending on the resolution, video compression format and the number of connected channels, **Standard Requirements** or **Advanced Requirements** shall be met. The **GV-USB Dongle** is only required for connections with GV-Recording Server / GV-Video Gateway, third-party (ONVIF & PSIA) IP devices and GV-IP devices directly.

Standard Requirements

OS	32-bit	Windows 7 / 8 / Server 2008
	64-bit	Windows 7 / 8 / Server 2008 R2 / Server 2012
CPU	Core i3 2120K, 3.3 GHz	
Memory	2 GB x 2	
Hard Disk	1 GB or more for installation	
Graphic Card	AGP or PCI-Express, 1024 x 768, 32-bit color	
DirectX	9.0c	
LAN	Gigabit Ethernet X 1	
Hardware	Internal or external GV-USB Dongle	

Note: It is recommended to use the internal GV-USB Dongle to have the Hardware Watchdog function which restarts the PC when Windows crashes or freezes.

Advanced Requirements

	64-bit	Windows 7 / 8 / Server 2008 R2 / Server 2012
CPU	Core i7 2600K, 3.4 GHz	
Memory	2 GB x 2	
Hard Disk	1 GB or more for installation	
Graphic Card	AGP or PCI-Express, 1024 x 768, 32-bit color	
DirectX	9.0c	
LAN	Gigabit Ethernet X 2	
Hardware	Internal or external GV-USB Dongle	

Note:

1. The memory required may vary depending on the number of channels and resolution of videos received.
2. It is recommended to use the internal GV-USB Dongle to have the Hardware Watchdog function which restarts the PC when Windows crashes or freezes.

Software License

Free License	When installed and executed on the same server with GV-DVR or GV-NVR
Maximum License	32 channels, 4 Matrix views
Increment for Each License	N/A
Optional Combinations	N/A
Dongle Type	Internal or external

The Advanced Requirements is highly recommended in any of the following conditions:

Resolution	Codec	No. of Connected Channels
CIF	H.264	32
VGA	H.264	12 or more
D1	H.264	11 or more
1MP	H.264	5 or more
2MP	H.264	3 or more
3MP	H.264	3 or more
4MP	H.264	3 or more
5MP	H.264	6 or more

Note: These data may vary in different scenes (different data bitrates).

Specifications

Channels		
Maximum No. of Channels		32
Maximum No. of Matrix Views		4
Dual-stream Support		Yes
Live View Access		
From GeoVision IP devices		Yes (GV-IP Decoder Box and GV-Pad)
From third-party surveillance software		Yes (through RTSP)
From mobile devices	Application	Yes <ul style="list-style-type: none"> • GV-Eye for iPhone / iPod Touch / Android Smartphone and tablet • GV-Eye HD for iPad
	Browser	Yes (http live streaming for iOS)
Using non-IE browsers		Yes (in MJPEG format)
General		
Language		Arabic / Bulgarian / Czech / Danish / Dutch / English / Finnish / French / German / Greek / Hebrew / Hungarian / Indonesian / Italian / Japanese / Lithuanian / Norwegian / Persian / Polish / Portuguese / Romanian / Russian / Serbian / Simplified Chinese / Slovakian / Slovenian / Spanish / Swedish / Thai / Traditional Chinese / Turkish

Note: Specifications are subject to change without notice.

Compatible Device

The following software versions have been tested for compatibility with GV-Mobile Server V1.3 or later:

- [GV-System V8.5.3](#) or later
- [GV-Recording Server](#) V1.1.0.0 or later
- [GV-Video Gateway](#) V1.1.0.0 or later
- [GV-IP Camera: V1.09](#) or later
- [GV-Video Server VS02A / VS04A / VS04H / VS12](#): V1.05 or later
- [GV-Video Server VS11](#): V1.0 or later
- [GV-Compact DVR V2](#): V1.07 or later
- [GV-Compact DVR V3 \(4-Channel\)](#): V1.01 or later
- [GV-Compact DVR V3 \(8-Channel\)](#): V1.00 or later

Compatible Standard and Protocol

GV-Mobile Server also allows for integration with third-party IP video devices that are compatible with ONVIF (V2.0) and PSIA (V1.1) standards.

ONVIF	PSIA	RTSP