

NV75M/MX

Installation Manual V1.0

16 Meter Indoor Dual Mironel Optics with Anti-Mask and Pet Immunity Dual Detector



Creep Zone/Pet Selection

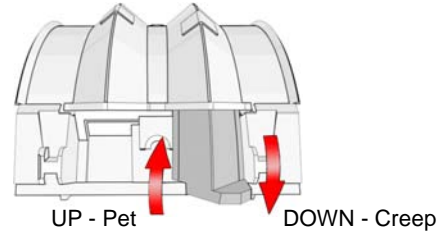

Note: Remove detector assembly as described in Fig. 1. When selector is UP, Pet Mode; when DOWN, Creep Zone is active and there is no Pet Immunity.

General Description

The NV75M/MX is an indoor industry-leading detector providing superior 16 meter detection with rock solid stability thanks to the revolutionary dual Mironel Mirror/Fresnel PIR optics. Combined with Paradox true Pet Immunity and best-in-the industry active Anti-Mask technology (EN Grade 3). The NV75M/MX provides an unmatched high security solution for any indoor installation.

Installing the NV75M/MX (Fig. 1)

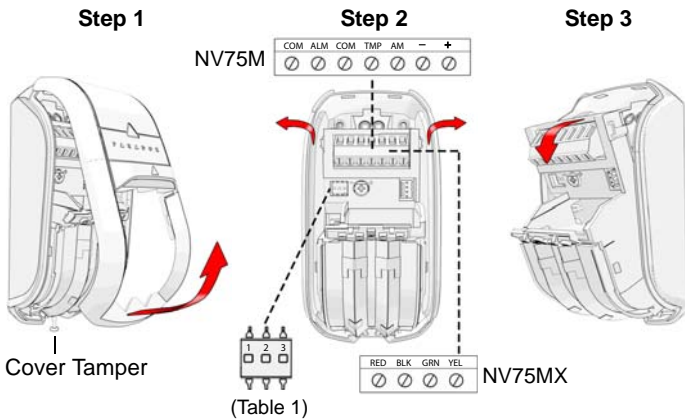

Wall Mount

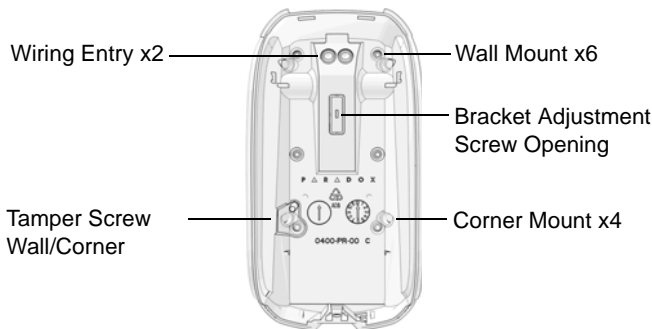

Bracket Mount

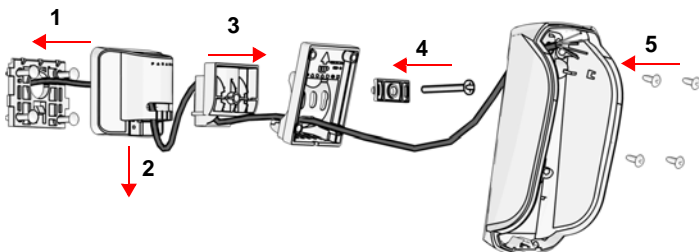

Dip Switch Settings

Table 1

DIP SWITCH	OFF	ON (DEFAULT)
1. LED	OFF	ON
2. EDGE	DUAL	SINGLE
3. FUTURE	FUTURE	FUTURE

Sensitivity Settings

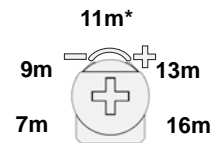

LED Display

Feature	LED Status Indicator
Tamper open	Green: ON for 0.3 seconds every 30 seconds
PIR sensitivity level setting	Green: Flashes 1-5 times according to the selected level
Alarm detection	Red: ON for 3 seconds
Booting/Tamper close	Green/Red alternating flashes for 45 seconds
Anti-mask detection	Flashes orange rapidly (pre-alarm state) and then constant orange when in alarm.

Programming the NV75MX via Keypad or Baby-Ware

Via Keypad

1. Enter EVO Installer Programming Mode, programming section **4003**.
2. Enter the detector's 8-digit **Serial Number**. Enter the 3-digit Section as per Table 2.

Table 2

Section [001]:

Bit	Function	Status/Description
[1]	LED	On: LED ON (default) Off: LED OFF

Section [002]:

Bit	Function	Status/Description
[3]	Future	Future
[4]	Edge	On: Single (default) Off: Dual

Section [003]: 00 (Low) to 04 (Max)

Via BabyWare

1. Double-click the serial number of the NV75MX to open the detector's programming.
2. Configure the required settings.

Beam Patterns

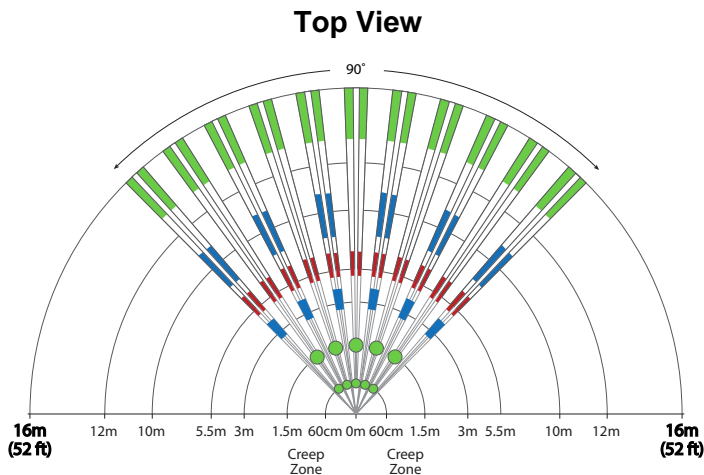

Side View

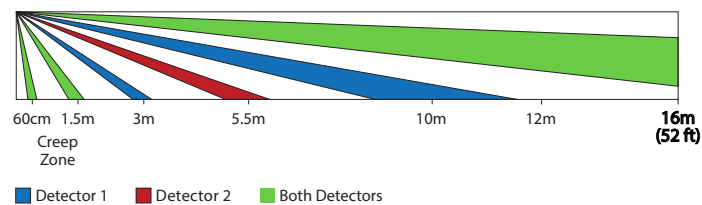

Warranty

For complete warranty information on this product, please refer to the Limited Warranty Statement is found on the website: www.paradox.com/terms or contact your local distributor. Specifications may change without prior notice.

Patents

US, Canadian and international patents may apply. Paradox is a trademark or registered trademark of Paradox Security Systems (Bahamas) Ltd.

Technical Specifications

Specification	Description
IR Movement Detection	2 detectors, 2 dual element sensors, 2 Mironel Optics
Optics	Two Mironel Mirror/W Fresnel optics with mechanical Pet / Creep Zone
Coverage	16 meters/52 feet; 90° - complies with EN50131-2-2 Grade 3
Anti-Masking	Active IR with Dual detectors, blocking items up to 30cm and lens applied materials including clear lacquer; meets and exceeds EN50131-2-2 Grade 3.
Pet Immunity	Pet up to 50cm will not be detected
Single/Dual Edge	Infrared detection requires entry or exit in single-mode; in Dual-edge, entry and exit is required for both detectors
Creep Zone	Mechanically selectable Creep Zone detection 1.5m/4ft. (cancels Pet Immunity when active)
Power - Wired Models	NV75M/NV75MX 23mA
Operating Temperature	-35° to 50° C (-31° to 122° F)
Relative humidity	95% non-condensing
Tamper	Dual - Cover and Wall
Dimensions	128 x 62 x 54 mm/ 5.1 x 2.4 x 2.1 in
Weight	120 gr/ 0.3 lb
Certifications	CE, EN50131-2-2 Grade 3, Class II