

# User Manual

## VIDEO DOOR PHONE CAV-35GN



- Thank you for purchasing COMMAX products.
- Please carefully read this User's Guide (in particular, precautions for safety) before using a product and follow instructions to use a product exactly.
- The company is not responsible for any safety accidents caused by abnormal operation of the product.



# Contents

1. Greetings.....	1
2. Warnings and caution.....	2
3. Part names and functions .....	4
4. Operation.....	5
5. BRIGHT / COLOR / CONT setting (Available only in monitoring mode .....	6
6. How to use lobby phone .....	7
7. Installation method .....	8
8. Wiring .....	8
9. Part list .....	9
10. Specifications .....	9



## 1. Greetings

- \* Thank you very much for purchasing of COMMAX products.
- \* Please read carefully this user manual and follow its rules.
- \* This intercom can be used in offices, and shopping outlets, and provide convenience to use communication on long distances.



## 2. Warnings and caution

Please follow the things described below in order to prevent any danger or property damage.



### Warning

It may cause a serious damage or injury if violated.



### Caution

It may cause a minor damage or injury if violated.



Prohibition.



No disassembly



No touch



Must follow strictly.



Shows plugging out the power cord without an exception



Shows the warning and caution for an electric shock.



Shows the warning and caution for a fire.



## Warning

### Power & Installation

Please don't use several products at the same time on one power socket.

- It may cause a fire due to an abnormal overheating.

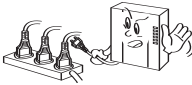

Prohibition Fire

Please don't bend the power cable excessively or it may cause an electric shock.

- fire when using a damaged power cable.

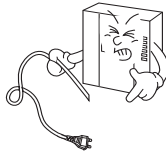

Prohibition Electric shock Fire

Please don't handle the power cable with a wet hand.

- It may cause an electric shock.

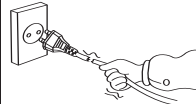

Prohibition Fire

Please plug out the power cable from the socket when not using it for a long period of time.

- It may shorten the product lifespan or cause a fire.

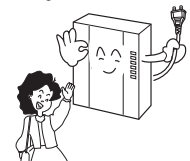

Request Fire

Please don't install the product in the place where there is much oil, smoke or humidity.

- It may cause an electric shock or fire.

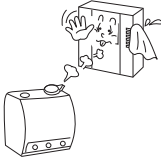

Prohibition Electric shock Fire

Please don't install the product with the lightning and thunder.

- It may cause an electric shock or fire.

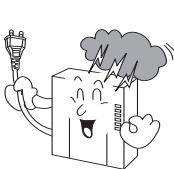

Prohibition Electric shock Fire

Please don't use and connect this product with other products with different rated voltage.

- It may cause a disorder or fire.

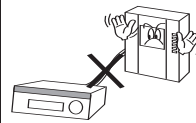

Prohibition Fire

When installing the product that generates heat, please install the product away from the wall (10cm) for the ventilation.

- It may cause a fire due to the increased internal temperature.

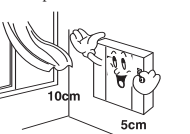

Prohibition Fire

## ⚠ Warning

### Cleaning & Use

Please don't disassemble, repair or rebuild this product arbitrarily (please contact the service center if a repair is needed).

- It may cause an electric shock or fire.

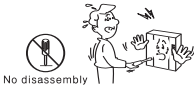

If an abnormal sound, burning smell or smoke is coming out of the product, please plug out the power cable and contact a service center.

- It may cause an electric shock or fire.



Please don't insert any metallic or burnable materials into the ventilation hole.

- It may cause an electric shock or fire.



Please use only the designated batteries for the products of using DC power.

- It may cause an electric shock or fire.



## ⚠ Caution

### Power & Installation

Please plug the power cable firmly into the inner end

- It may cause a fire.

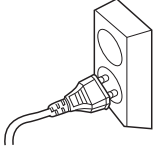

Please hold the plug tightly when unplugging the power cable (a part of the copper wire may be disconnected if the grabbing is only made on the cord when pulling out the cable).

- It may cause an electric shock or fire



When connecting the power cables after cutting the cable, please install the product with power off

- It may cause an electric shock or fire



When installing the product, please fix it firmly while using the wall-mounting unit and screws.

- It may cause an injury from the falling object.

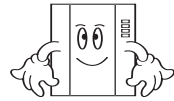

Please be careful when using an AC circuit breaker since there is a possibility of an electric shock.

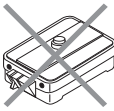

Please check the use voltage and current for the DC-only products and use the appropriate rectifier.

- It may cause a fire.



Please avoid direct rays of the sun or heating devices at a time of installation.

- It may cause a fire.



Please don't install the product on an unstable place or small support board.

- It may cause an injury if it falls down while in use.



### Cleaning & Use

When cleaning the product, please rub it with a soft and dry cloth after plugging out the power cable. (Please don't use any chemical products such as wax, benzene, alcohol or cleanser.)



Prohibition

Please don't drop the product on the ground and don't apply a shock.

- It may cause a failure.

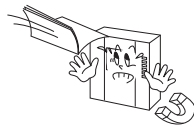

Prohibition

Please use the designated connection cable within the maximum calling distance designated for the product

- It may reduce the product performance.



Request



### 3. Part Names and Functions

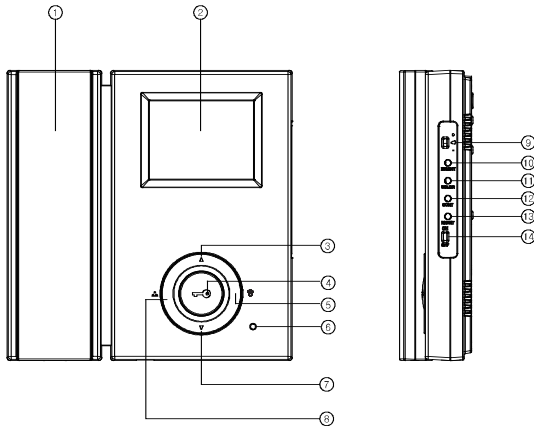

No.	Part name	Description
1	Handset	The phone's handset receiver
2	Screen	3.5" TFT LCD
3	UP Button	Adjust BRIGHT / CONT / COLOR
4	Door open button	Door strike of Relevant camera is run during the status of door communication
5	Guard button	Call to guard station after picking up handset
6	Power indicator	LED Light
7	DOWN Button	Adjust BRIGHT / CONT / COLOR
8	Monitoring button	Press this button to check the entrance status
9	Volume switch	Control incoming volume
10	BRIGHT button	Press this button to control BRIGHT
11	COLOR button	Press this button to control COLOR
12	CONT button	Press this button to control CONT
13	RESET button	Button to return the default of screen on Color, Brightness
14	Power switch	ON / OFF switch



# 4. Operation

## 1. Calling of visitor

### 1-1. Call from the individual entrance

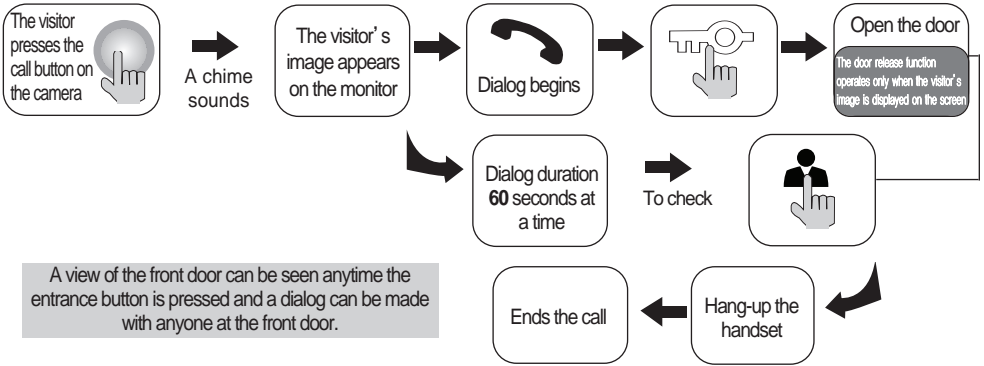

### 1-2. Call from the common entrance

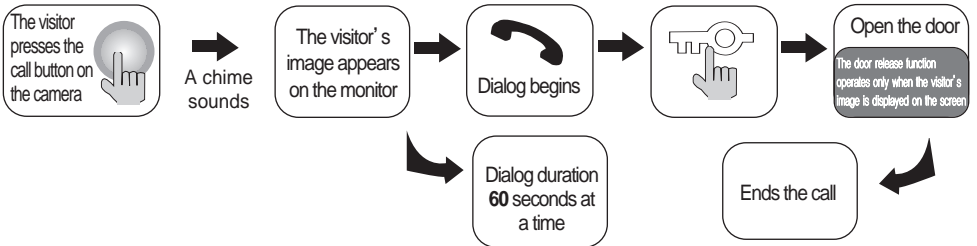

### 1-3. Communication between guard station and household

#### ① Paging guard station



- \* Pick up the handset and press Security call button
- \* Emit call sound.
- \* Dialog begins when the security answers.

#### ② Call from guard station

- \* Power light blinks with call sound.
- \* Pick up the handset and talk.
- \* hang up the handset when the conversation is finished.

#### 1-4. Monitoring

① In case both lobby and individual cameras are installed

\* Click the monitor button once in standby mode to check the images from Individual camera. Click the button twice for Lobby images and three times for returning to standby mode. (Note. it is not available during the talk)

② In case only lobby camera is installed.

\* Click monitor button once in standby mode to check the images from lobby and click the button twice to return to standby mode



## 5. BRIGHT / COLOR / CONT setting (Available only in monitoring mode)

### 1). BRIGHT setting

- ① Press the monitoring button when the handset is hung on normally. (LED light off)
- ② Power LED is blinked as fast (BRIGHT control mode)
- ③ Control the BRIGHT as the user wants by pressing UP / DOWN button
- ④ Press BRIGHT button once again to save the new settings after the completion of setting
- ⑤ Power LED is blinked as normal

### 2). COLOR setting

- ① Press the monitoring button when the handset is hung on normally. (LED light off)
- ② Power LED is blinked as fast (COLOR control mode)
- ③ Control the COLOR as the user wants by pressing UP / DOWN button
- ④ Press COLOR button once again to save the new settings after the completion of setting
- ⑤ Power LED is blinked as normal

### 3). CONT setting

- ① Press the monitoring button when the handset is hung on normally. (LED light off)
- ② Power LED is blinked as fast (CONT control mode)
- ③ Control the CONT as the user wants by pressing UP / DOWN button
- ④ Press COLOR button once again to save the new settings after the completion of setting
- ⑤ Power LED is blinked as normal

### 4). RESET (Video Status initialization)

- ① Press the Reset button in status of the screen on
- ② Video status is initialized to the factory delivery status

※ When you wish to control above functions one after another in a row press next button without procedure No ④, and then use UP/DOWN button take procedure No ④ when the adjustments are finished.



## 6. How to use lobby phone

### 1) Paging a household

- Press the household number  
ex) household 101 → 1, 0, 1
- Household number appears on FND
- Press the Call button (E)
- Conversation begins when household pick up the phone

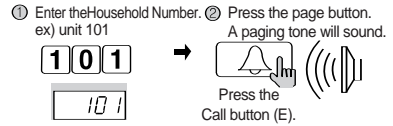

### 2) Paging a guard station

- Press the guard button
- 'gUAd' appears on FND
- Press the Call button (E)
- 'gUAd' message blinks on FND with call sound.
- Conversation begins when guard station pick up the phone

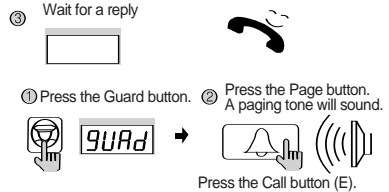

### 3) Opening the door with PIN

- Press the Household number
- Press the Key button (K)
- 'PASS' blinks on FND
- Press the household PIN
- '-----' appears on FND
- Press the Call button
- 'oPEn' message blinks on FND and door will open.

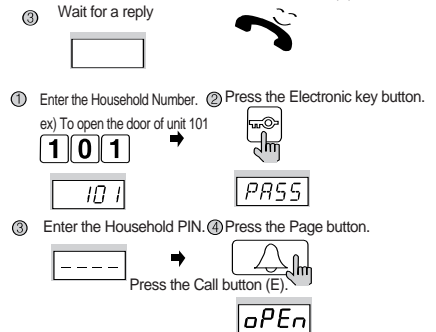

#### [Reference for use]

If you don't recall household PIN, please contact a guard station or management station.

### 4) Registering household PIN

- Press the Key button (K)
- Press program number '20'
- Press the Call button (E): 'hono' message blinks on FND
- Press the household number
- Press the Call button (E): 'PASS' message blinks on FND
- Input current household PIN. (factory default: 1,2,3,4)
- Press the Call button (E): 'PASS' blinks on FND
- Input new PIN (ex:3,6,9,0)
- Press the Program button (P). Completion of changing PIN

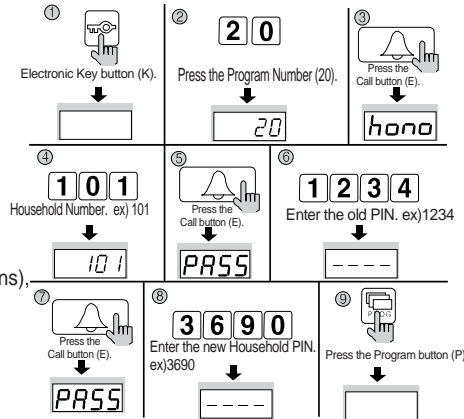

### 5) Use RF-ID card for door open (optional)

- When get the RF card to the sensor ( below camera lens), door will open with message of 'oPEn' on FND

#### [Reference for use]

- ① If unregistered card comes close to the sensor, guard stations unit has to be informed the situation automatically with the call. Please register RF card first at management office first.
- ② If you can not open the door with properly registered RF card







# 7. Installation method

## 1. Installation Method of camera monitor

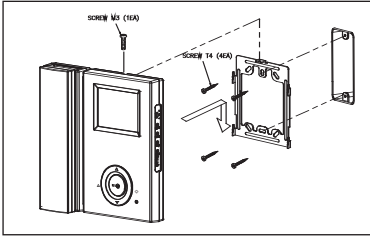

### ! Note

- ① Avoid the range of direct sunlight
- ② Recommended height is pertinent from 1450 ~ 1500mm
- ③ Avoid the installation near magnetic activity, humid temperatures and gas

## 2. Installation Method of camera

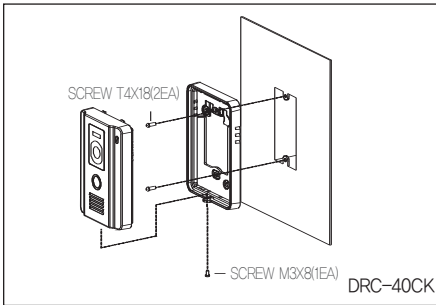

### ! Note

- ① Do not install the camera where it is exposed to Direct sunlight
- ② Keep cleaning up its lens to capture good views.



# 8. Wiring

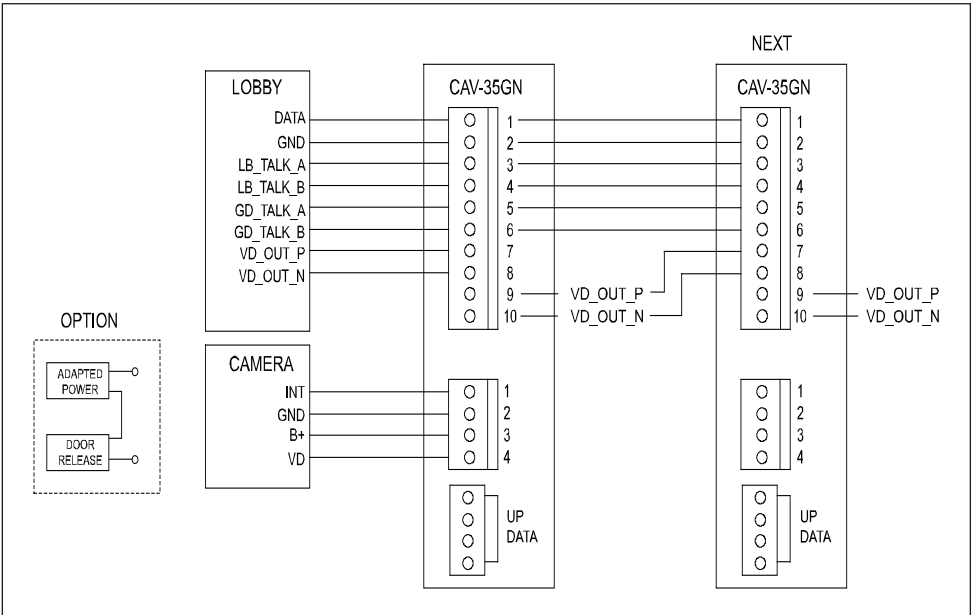

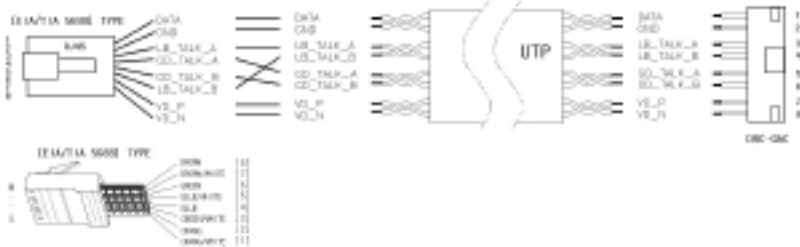

## 2. Wiring precautions

- 1) If high voltage cables are present in the vicinity, use a coaxial cable with metal outer casing.
- 2) If any internal wires are exposed through mis-wiring, it may cause a short and become a cause of malfunction or fire.
- 3) When connecting the monitor and camera, please make sure that the monitor power is off.(turn on the power after plugging the AC power cord into the outlet)
- 4) Please be aware that the wire between camera and monitor has polarity
- 5) Please be aware that the wire between CAV-35GN and common entrance has polarity.

## 9. Part list

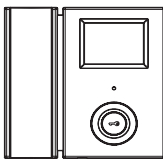

Body of CAV-35GN

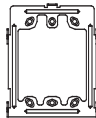

Bracket for wall mount

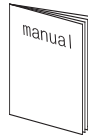

Manual



## 10. Specifications

Model	CAV-35GN
Rating Voltage	100-240V~, 50/60Hz
Consumption	Operation : Maximum 7W
Wiring method	To a Camera unit:4 wires polarity, To a Lobby:8 wires polarity
Monitor	3.5" TFT LCD (8.9cm)
Communication	Full duplex (Handset)
Call tone	Call sound from camera: electronic chime, Interphone : electronic buzzer
Monitor Display	60±10sec
Distance from Camera	28m(φ0.5) / 50m(φ0.65) / 70m(φ0.8)
Working Temperature	0 ~+40°C (32°F ~ 104°F)
Weight	700g (Based on Body)
Dimension(mm)	192mm(W)X195mm(H)X48.5mm(D)(Based on Max height of handset)

**COMMAX**