

GV-SNVR1611

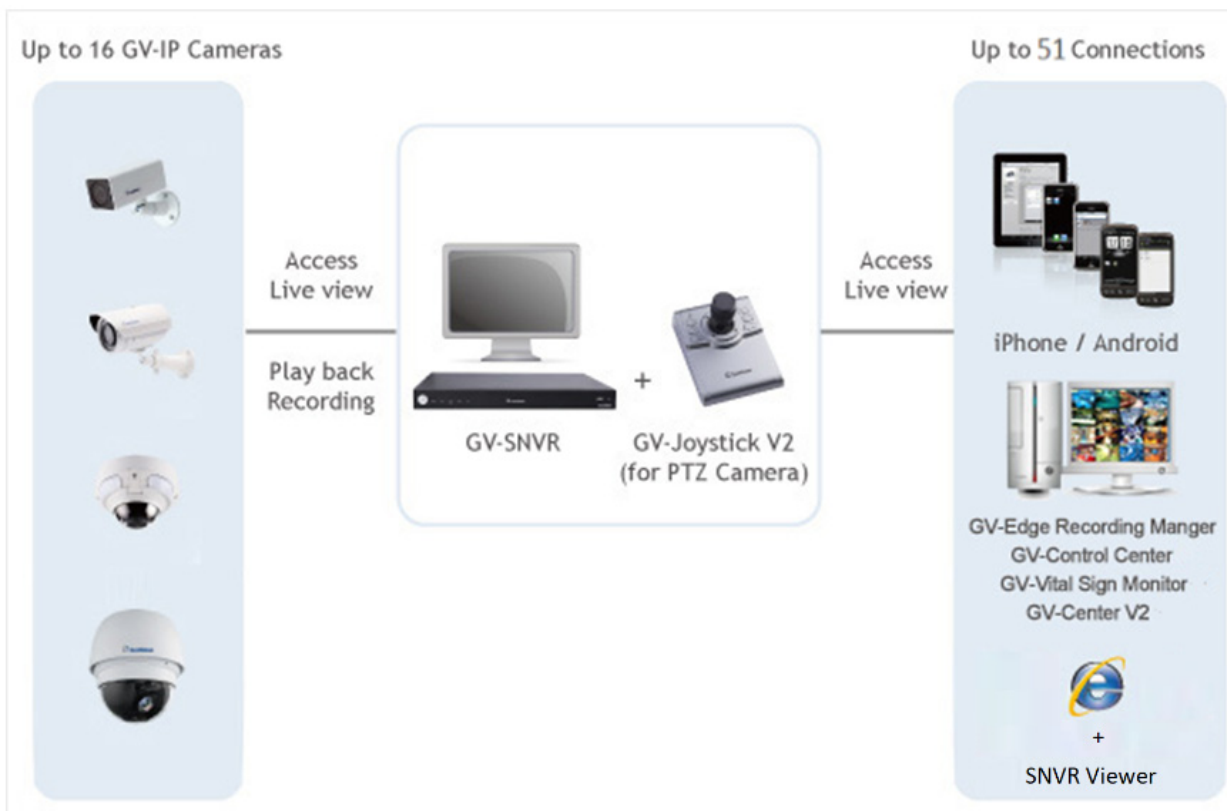

Introduction

The GV-SNVR1611 is an H.264/H.265 Linux-embedded Standalone Network Video Recorder which records video files directly to the internal hard drive, supporting up to 16 channels of IP cameras for network surveillance. GV-SNVR1611 has 16-port built-in PoE+ (IEEE 802.3at), functioning to carry network and power to IP cameras. Featuring with up to 4K resolution video output, GV-SNVR1611 eliminates the need of a separate PC to view and play back video from the unit. Its USB ports allow you to connect a USB flash drive to import or export system settings, update firmware, save snapshot files and back up video in AVI format.



Features

- 16-Channel video recording
- Up to 4000 x 3000 resolution for each channel*
- Dual stream support
- 16-Port PoE+ (IEEE 802.3at) for camera connection
- 4K HDMI / 1080p VGA video output
- 2 SATA HDD drawer (3.5") for up to 8 TB storage
- Two-way audio
- Four sensor inputs and one alarm output
- Automatic search and setup for IP cameras
- Support for third-party IP cameras through ONVIF and RTSP protocol
- Continuous, motion, alarm and scheduled recordings
- Timeline playback
- Multi-channel playback
- Display of HDD status and temperature
- DST (Daylight Saving Time) support
- NTP (Network Time Protocol) support

- GeoVision DDNS server support
- E-mail notification for recording error and password retrieval
- Recording export
- Remote live view through Web browser
- Support for GV-Video Server through RTSP protocol
- PTZ control using GV-Joystick or on-screen panel
- Smart device access (iOS and Android)
- Support for 14 languages

*The resolutions of Main Stream and Sub Stream both must meet the requirements noted under Specifications.

Specifications

Hardware

System		
OS	Embedded Linux	
No. of Drive Bay	2 (3.5" HDD) up to 8 TB	
Power Source	Input: AC 100 ~ 240V, 50 ~ 60 Hz Output: DC 52V, 4.6A, Max. 280W PoE: Max. 240W	
Connectors	Megabit Ethernet	1 port for WAN, RJ-45 10/100/1000 Mbps, 16 ports for LAN, RJ-45 10/100 Mbps, PoE+ (IEEE 802.3at)
	Video Output	HDMI / VGA
	Audio	RCA
	USB	Front: USB 2.0 x 1 Port, Rear: USB 3.0 x 1 Port
	I/O	4 Inputs, 1 Output
LED Indicator	NVR	4 LEDs: Power, HDD Error, HDD1, HDD2
	PoE	16 LEDs, 1 for each port
Operating Temperature	0°C ~ 50°C (32°F ~ 122°F)	
Humidity	0% ~ 90% RH (non-condensing)	
Dimensions (L x W x H)	380 x 315 x 46 mm (15 x 12.4 x 1.8")	
Net Weight	2.48 kg (5.47 lb)	
Regulatory	FCC, CE, BSMI, PSE, RoHS compliant	

Software

Video and Audio		
Video Compression	H.264, H.265	
Video Stream	Dual streams from H.264, H265	
Video Output	4K (HDMI) / 1080p (HDMI/VGA)	
Display Division	1 / 4 / 6 / 8 / 9 / 16	
Audio Compression	G.711	
Audio Support	Yes	
Two-Way Audio	Yes	
Supported Video Resolution	Main Stream	Sub Stream
Firmware Version	V3.0	
4:3	4000 x 3000	1280 x 1200, 1024 x 768, 960 x 720, 640 x 480, 320 x 240
	2560 x 1920	
	2048 x 1536	
	1600 x 1200	
	1280 x 960	
	640 x 480	
16 : 9 (Default)	3840 x 2160	1280 x 720, 640 x 360, 448 x 256
	2592 x 1520	
	2560 x 1440	
	2304 x 1296	
	1920 x 1080	
	1280 x 720	
	640 x 360	
5:4	1280 x 1024	1280 x 1024, 640 x 512, 320 x 256
	640 x 512	

Operation	
Recording Bandwidth	Max. 320 Mbps for 16 channels
Recording Mode	Round the clock / Motion Detection / Alarm / Schedule Recording
Pre Recording	1 ~ 10 sec.
Post Recording	30 sec.
Instant Playback	3 min.
Backup Type	USB flash drive of FAT32 format
Note: For backup efficiency, it is recommended to use external hard drive(s) to back up your recordings.	
Management	
Language	Czech / English / Finnish / French / German / Hungarian / Italian / Japanese / Portuguese / Russian / Slovakian / Slovenian / Spanish / Traditional Chinese
Firmware upgrade	Upgrade through OSD, Web or GV-IP Device Utility
Network	
Network Type	LAN, WAN, Internet
Protocol	DHCP, DynDNS, HTTP, NTP, ONVIF, RTSP, TCP, UDP
System Monitoring and Recovery	
Power Restoration	Automatic restart after power outage
Monitoring	Software Watchdog
Remote Viewing	
Live View	Max. 51 channels connection
Monitoring Environment	IE browser, SNVR Viewer for non-IE browsers, Mobile app
Smart Device Access	GV-Eye for iOS and Android
Access from IE browser	Live View, Image Snapshot, Picture in Picture, Picture and Picture, Digital PTZ

Note:

1. GV-SNVR1611 only supports PoE+ (IEEE 802.3at) for camera connection. If your camera requires power supply above 30W, be sure to power your camera with the compatible PoE switch or its power adapter.
2. Product design and specifications are subject to change without notice.

Accessories

GV-POE Switch	GV-POE Switch is designed to provide power along with network connection for IP devices. It is available in various models with different numbers and types of ports.
GV-Joystick V2	GV-Joystick V2 facilitates PTZ camera controls. It can be plugged into the GV-SNVR for independent use to empower the operation of PTZ cameras.
GV-WiFi Adaptor V2	Designed to connect IP devices to a wireless network, GV-WiFi Adaptor V2 is a plug-and-play device that can be plugged into the USB port of GV-SNVR to provide immediate WiFi connection.

Requirements

Supported GV-IP Cameras

- GV-Target Series IP Camera (Firmware V1.0 or later)
- GV-SD220/220-S (Firmware V1.02 or later)
- All other GV-IP Cameras (Firmware V2.11 or later) EXCEPT for the models below:
 - GV-BX110
 - GV-BL110
 - GV-FER12203
 - GV-MFD110
 - GV-PT110
 - GV-PTZ010D
 - GV-SD010

Note:

1. For supported IP cameras, the resolutions of Main Stream and Sub Stream both must meet the requirements noted under Specifications.
2. GV-SNVR only supports recording frame rates of up to 30 fps.
3. GV-SNVR1611 only supports recording bandwidths of up to 80 Mbps.
4. GV-SNVR1611 also supports EVS-ABD1300 / ABL1300 / ADR1300 and UVS-ABD1300 / ABL1300 / ADR1300.

Supported GeoVision Application

- GV-Edge Recording Manager (Windows Version V1.2.0.0 or later)
- GV-Control Center (V3.4.0.0 or later)
- GV-Center V2 (V16.11 or later)
- GV-Vital Sign Monitor (V16.11 or later)
- GV-Eye (V2.5.1 or later)
- GV-Cloud Center (V1.0 or later)

Recommended Hard Disks

GV-SNVR1611 supports 2 SATA HDD (3.5") with up to 16 TB of storage capacity, combined. For system efficiency, it is recommended to use enterprise-level hard disk drives instead of desktop-level or green HDD. For tested hard disk drives, see Appendix in GV-SNVR User's Manual.

Note: GV-SNVR does not support 2.5" SATA HDD.

Supported Web Browsers

- Internet Explorer 8 or later
- Google Chrome
- Mozilla Firefox
- Safari
- Microsoft Edge

Overview

Front Panel



Back Panel



Packing List

1. GV-SNVR1611
2. AC power cord
3. SATA cable x 2
4. HDD power cable x 2
5. Screw x 8 (for HDD)
6. USB mouse
7. Foam foot
8. Download Guide
9. Warranty card